

# Parking & Transportation

**The TRACK at New Balance**  
91 Guest St, Boston, MA 02135

**Important Note:** Please plan for an additional 10-15 minutes to make sure you and your students have enough time to park and arrive at showcase by 9:00am (set-up starts as early as 8:30; opening remarks begin at 9:15).

## 3 Transportation Options

### 1. Parking for Cars & Vans less than 8':

- **77 Guest Street – Paid Parking** (*8ft Height Restriction*)  
Access on Life Street entrance across from NB Fitness Club.
- **Multi-Colored Garage: 15 Guest Street – Paid Parking** (*6' 10" Height Restriction*)  
Access on Guest Street – the same building as NB Fitness Club.

### 2. Taking Public Transit:

- **By Commuter Rail:** Take the **Commuter Rail** to the Boston Landing stop.
- **By Bus:** MBTA bus stops are conveniently located on Market Street and Guest Street that provide access to both downtown Boston and Cambridge.
  - **#64** to and from Central Square
  - **#86** runs to/from Harvard Sq & Cleveland Circle, provides access to Red & Green lines
  - **#70** or **#70A** to North Waltham or Watertown Sq.

### 3. Bus Drop Off & Pick Up

- Buses will not be able to park on site; bus drivers should find their own parking around Boston to wait between drop off and pick up
- Bus drop off and pick up will occur on New Balance Way, the street adjacent to the entrance of the TRACK. Please the map below for the exact location.

See map on back

## Map:

Map shows the entrance to The TRACK where showcase will take place, all the available parking garages and the designate bus drop off locations.

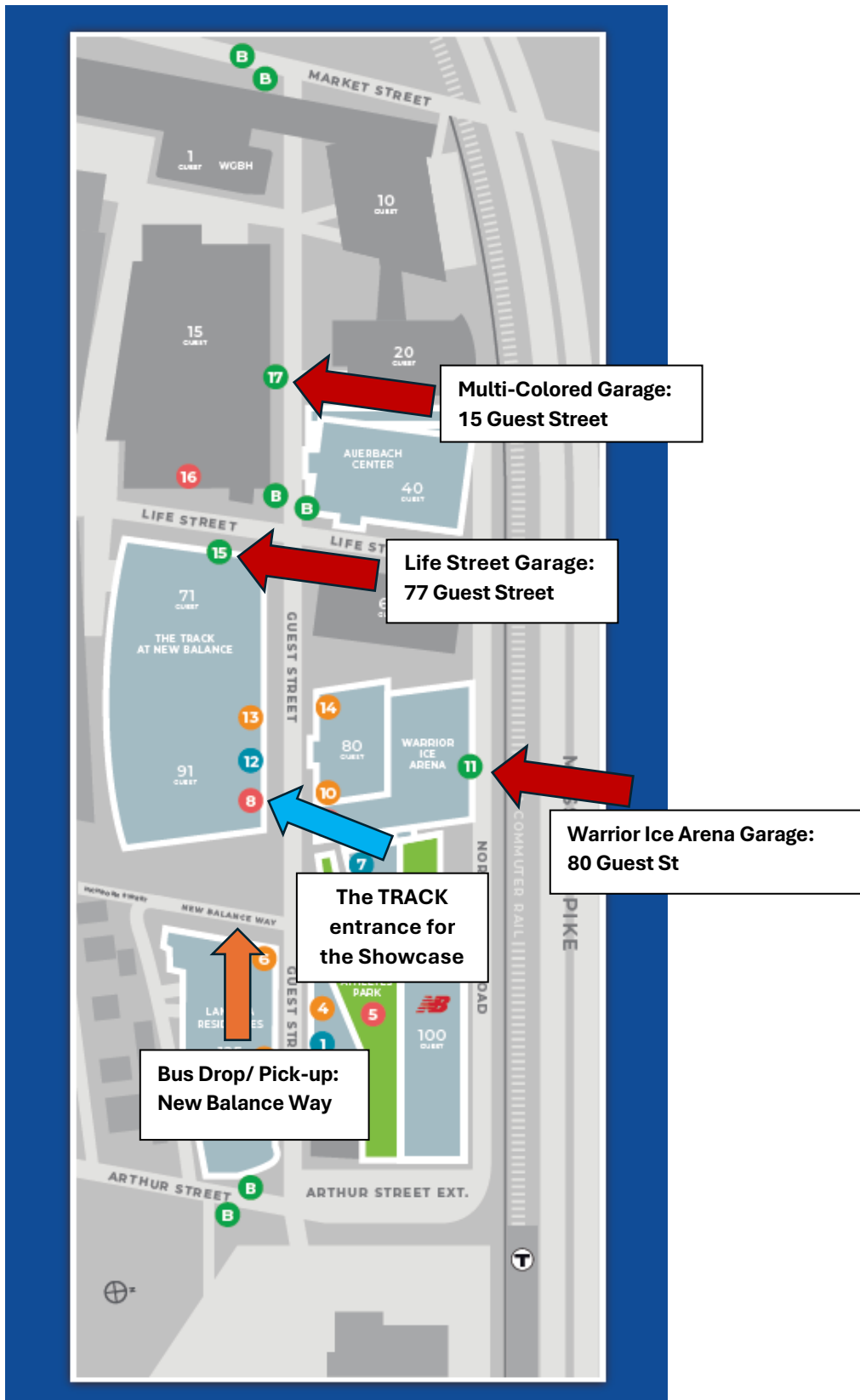

Questions? Reach out to Julia Kostro at [jkostro@one8.org](mailto:jkostro@one8.org).